

PLAQUE INSTALLATION INSTRUCTIONS

FIRST POSITION YOUR TEMPLATE ON THE SIGN WALL AND SECURE WITH TAPE.
CHECK TO SEE THAT IT IS TRUE HORIZONTALLY & VERTICALLY.

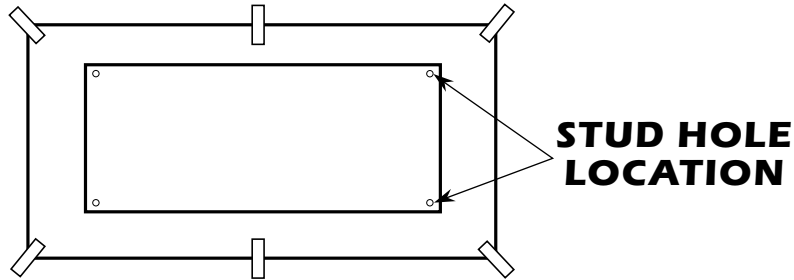

TYPICAL CONCEALED MASONRY WALL MOUNTING

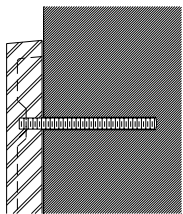

1. USING A CARBIDE-TIPPED MASONRY BIT, DRILL THROUGH EACH HOLE LOCATION MARK. USE THE SAME DIAMETER BIT AS YOUR STUD DIAMETER AND MAKE THE HOLE SLIGHTLY LONGER THAN THE LENGTH OF YOUR STUD.
2. REMOVE THE TEMPLATE AND CLEAN OUT THE DUST AND RESIDUE FROM YOUR DRILLED HOLES. FAILURE TO CLEAN OUT THE HOLE WILL RESULT IN NON-ADHESION OF THE STUDS.
3. SCREW THE STUDS INTO THE BACKS OF THE PLAQUE.
4. SQUEEZE A SMALL AMOUNT OF ADHESIVE ONTO THE END OF EACH STUD, PRESS PLAQUE INTO THE WALL AND MAKE FINAL ALIGNMENT. ALLOW TO SET.

TYPICAL EXPANSION BOLTS FOR MASONRY WALL MOUNTING

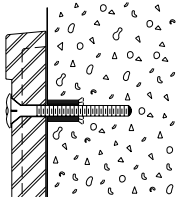

1. USING A CARBIDE-TIPPED BIT, DRILL THROUGH EACH HOLE LOCATION MARK.
2. REMOVE THE TEMPLATE AND CLEAN OUT THE DUST AND RESIDUE FROM YOUR DRILLED HOLES.
3. TAP IN EXPANSION SHIELD.
4. INSERT SCREW THROUGH PLAQUE AND SCREW INTO EXPANSION SHIELDS.
5. ONCE PLAQUE IS ON WALL TAP ROSETTES LIGHTLY INTO SCREW HEADS.

TYPICAL DRYWALL MOUNTING

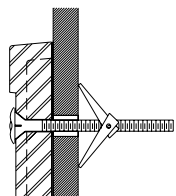

1. DRILL HOLE THROUGH DRYWALL (FOLLOWING TEMPLATE LOCATION HOLES)
2. REMOVE THE TEMPLATE AND SLIDE THE SCREWS THROUGH THE PLAQUE.
3. PLACE PLAQUE ON WALL AND PUSH WING NUTS THROUGH HOLES AND THROUGH WALL.
4. TIGHTEN THE SCREWS (DO NOT OVER TIGHTEN)
5. ONCE PLAQUE IS ON WALL TAP ROSETTES LIGHTLY INTO SCREW HEADS.

TYPICAL WOOD SCREW WALL MOUNTING

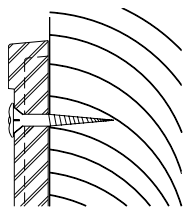

1. DRILL 1" DEEP HOLE OVER TEMPLATE LOCATION HOLES.
2. MAKE SURE THE HOLES ARE SLIGHTLY SMALLER THEN THE SIZE OF THE SCREW.
3. INSTALL SCREWS (DO NOT OVER TIGHTEN)
4. IF ADDING ROSETTES, ONCE PLAQUE IS ON WALL TAP ROSETTES LIGHTLY INTO SCREW HEADS.

R

A.R.K. RAMOS

ARCHITECTURAL SIGNAGE

EMAIL: CUSTOMERSERVICE@ARKRAMOS.COM

800-725-7266

1321 SOUTH WALKER AVENUE.

fax: 405-232-8516

OKLAHOMA CITY, OK 73109